



Burlington Apartments 100, Anerley Park

London, SE20 8NR

Offers In Excess Of £325,000

Welcome to Burlington Apartments, a delightful flat located in the charming area of Anerley Park, Penge, London, SE20. This modern property, built in 2006, offers a comfortable living space of 584 square feet, making it an ideal choice for individuals or small families seeking a contemporary home.

As you enter the flat, you will find a spacious reception room that seamlessly integrates with a modern open plan kitchen, creating a perfect environment for both relaxation and entertaining. The living area is enhanced by a lovely Juliet balcony, allowing natural light to flood the space while providing a pleasant view of the surroundings.

The property boasts two generously sized double bedrooms, ensuring ample space for rest and privacy. The well-appointed bathroom adds to the convenience of this home, catering to all your daily needs.

One of the standout features of this flat is its excellent location. Situated within walking distance of both Penge West and Penge East stations, commuting to central London is a breeze. Additionally, the nearby Crystal Palace Park offers a beautiful green space for leisurely strolls and outdoor activities, making it a perfect retreat from the hustle and bustle of city life.

For those with vehicles, the property includes one allocated space in a secure gated underground parking area, providing peace of mind and easy access.

- TWO BEDROOM FLAT
- JULIET BALCONY
- SECOND FLOOR
- WELL KEPT MODERN BUILDING
- SHARED TERRACE AREA
- ALLOCATED UNDERGROUND PARKING
- 4 MINUTE WALK TO CRYSTAL PALACE PARK
- 2 MINUTE WALK TO PENGE WEST STATION
- 9 MINUTE WALK TO PENGE EAST STATION
- (ALL WALKING TIMES ARE ESTIMATED VIA GOOGLE MAPS)

Viewing

Please contact our Galloways Penge Office on 020 8778 1120 if you wish to arrange a viewing appointment for this property or require further information.



Floor Plan

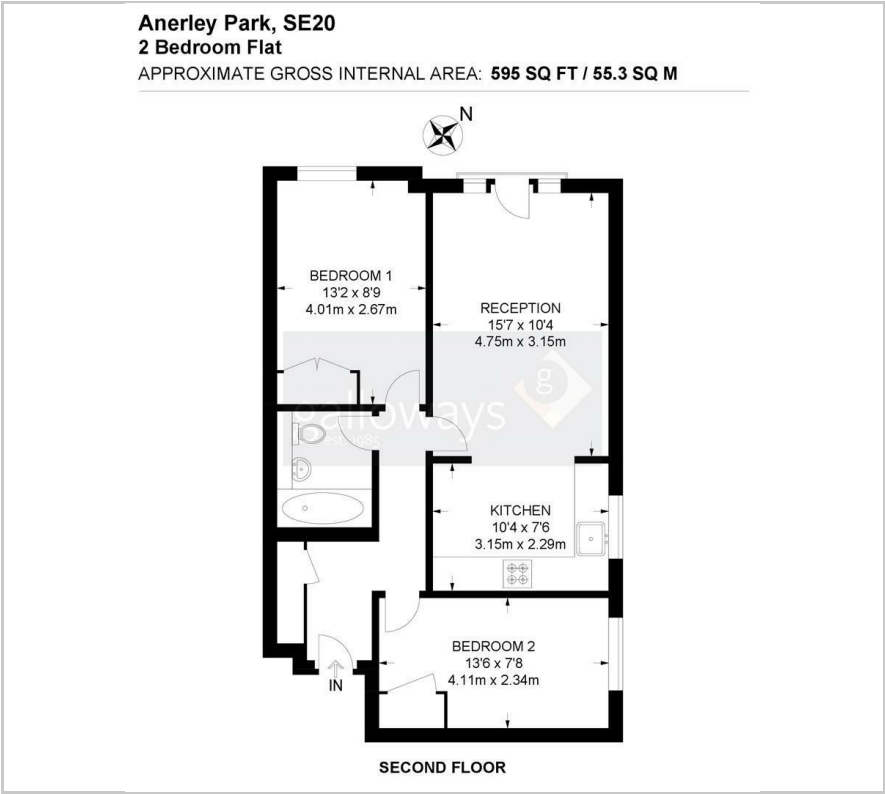

Area Map



Energy Efficiency Graph

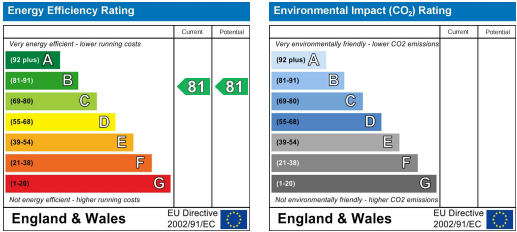

These particulars, whilst believed to be accurate are set out as a general outline only for guidance and do not constitute any part of an offer or contract. Intending purchasers should not rely on them as statements of representation of fact, but must satisfy themselves by inspection or otherwise as to their accuracy. No person in this firms employment has the authority to make or give any representation or warranty in respect of the property.